

# What...

**GROVE PARK**  
Williamson County  
College Grove, TN 37046

The sun seems to set a little slower and the evening breeze seems a little sweeter in this quiet corner of Williamson County... and yet only a 10-15 minute drive can take you into the heart of Franklin and Cool Springs with all the restaurants, entertainment, and shopping you could wish for. **Grove Park** is an estate community with lots ranging from 2-5 acres in a picturesque setting of wooded and non wooded home sites. Call Sherlock today for a listing of available sites and floor plans.

Estates from the \$400,000 to \$500,000 (House & Lot).

Lot	Acres	Lot	Acres
201	2.07	207	3.2 <b>RESERVED</b>
202	2.07	208	1.81 <b>RESERVED</b>
203	2.07 <b>RESERVED</b>	209	2.01
204	1.96	210	2.21
205	2.63 <b>RESERVED</b>	211	2.04 <b>RESERVED</b>
206	4.59 <b>RESERVED</b>	212	4.47 <b>RESERVED</b>

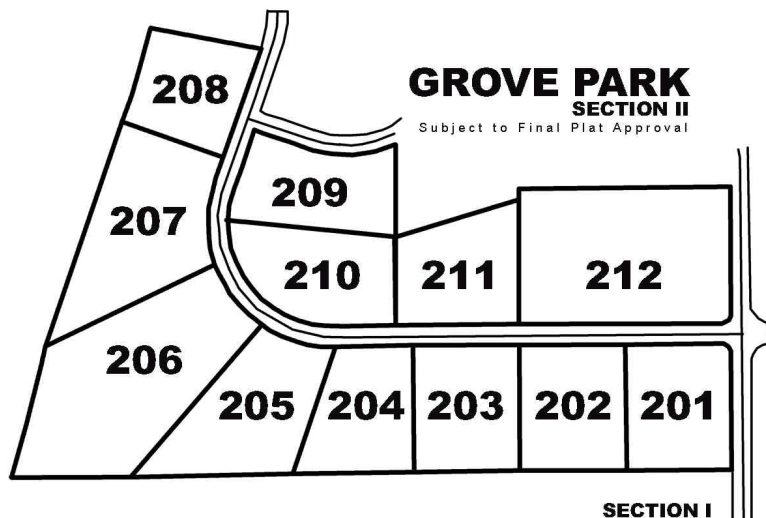

# Where...

Take 65 south to 840 (exit 59A). Once on 840 head toward Murfreesboro for 10 miles until you come to exit #42... exit 42 will put you on 31A, travel south on this road for 4.2 miles which will take you into College Grove. Turn right, opposite the old Methodist Church onto Arno-College Grove Road, this road will go over a RR track and then past an elementary school on the right... take the first immediate right past the school, then your first drive on the left is the model home. Phase II begins at the dead-end of Phase I.

# Who...



Sherlock Homes Builders, Inc. has been family owned and operated since 1968 and is one of the most respected builders in the area. Everybody advertises quality and price, but Sherlock has a thirty-plus year reputation of delivering on that promise. Including in the base price what others consider extras, there is never a question what your dollar buys at Sherlock. Come visit with us and see our beautiful new addition to Grove Park.

# When...

Sherlock is currently taking reservation deposits. All individuals with reservations will have 5 days after Final Plat approval by the county (expected mid Dec. 2007) to approve the plat and confirm their reservations. Upon acceptance of the final plat all reservation holders will have 30 days to finalize a construction contract with Sherlock and construction must commence within 60 days of the finalized contract.

# How...

- **Reservation** - \$1,000
- **Review** - upon County approval of plat (expected by mid Dec 2007) Buyer will have 5 days to review
- **Contract**: within 30 of plat acceptance
- **Construction** - must commence within 60 days of finalized contract
- **Completion** - home completion est.-130 days